

The information contained in this drawing is the sole property of CWS Coil Winding Specialist. Any reproduction in part or whole without written permission of CWS Coil Winding Specialist is prohibited.

REVISION HISTORY

REV	ECN	DESCRIPTION	DATE	BY	CHK	DATE
A		PRE-PRODUCTION RELEASE	7/13/04	JLU		7/14/04

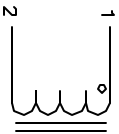

USING A PERMANENT MARKING METHOD  
 MARK PART NUMBER AND REVISION, IF APPLICABLE  
 IF NEEDED, WRAP INDUCTOR WITH GLASS TAPE

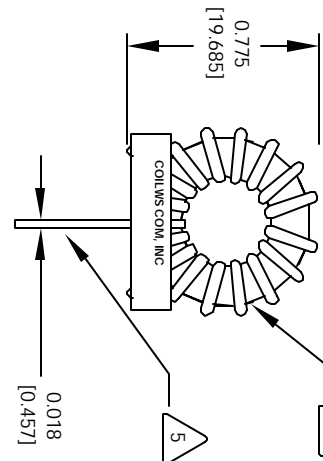

FRONT VIEW

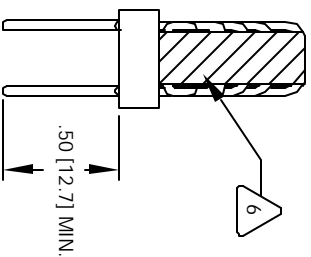

SIDE VIEW



TO THE CORE  
 MUST REST FLAT ON PCB. LEADS MUST BE TANGENT  
 FLUSH WITH THE COIL EDGE, AS SHOWN (I.E. COIL  
 REMOVE INSULATION AND TIN LEADS 0.50 INCH

4 WIND COILS EVENLY SPACED AROUND THE CORE  
 CONSTRUCTION:

HI-POT TEST FOR WINDING TO CORE ISOLATION = 500VDC MIN  
 CURRENT RATING : 1.9 AMPS, 40 °C TEMP. RISE, NO AIR FLOW  
 DCR = 160.0 MILLI-OHMS MAX.

DC BIASED = 1.9 AMPS, INDUCTANCE = 158 UH  
 DC BIASED = 1.4 AMPS, INDUCTANCE = 200 UH  
 INDUCTANCE = 250 UH +-10% @ LOW DC BIAS, 1 KHZ, 250mV

3 SPECIFICATIONS:



WIRE: UL RECOGNIZED 200°C RATED MAGNET WIRE  
 CWS BYTEMARK OR OTHER APPROVED PART  
 CORE: COATED HIGH FLUX TOROIDAL CORE

1 RATING CLASS B (130°C MIN.) REQUIRED  
 MATERIAL: UL RECOGNIZED 94V-0 FOR FLAMMABILITY

NOTES: TOROIDAL POWER CHOKE. ALL DIMENSIONS IN INCHES

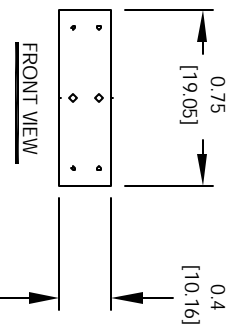

FRONT VIEW

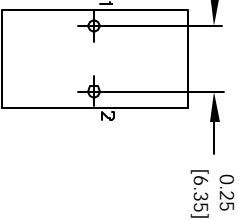

MOUNTING HOLES PATTERN

CODE IDENT	MFG. P/N	DESCRIPTION	ITEM NO.
AUTOCAD SOLIDWORKS SIGN	X		
UNLESS OTHERWISE SPECIFIED TOLERANCE PER ANSI Y14.5M AND DIMENSIONS ARE IN NOTES AND DIMENSIONS			
TOLERANCE INCHES: .XXX±.005 .XXX±.015 .XXX±.020 .XXX±.030 .XXX±.050 .XXX±.127			
ANGLE PROJECTION			
DO NOT SCALE DRAWING			
DATE	DATE	TITLE	REV
7/13/04	7/13/04	Toroidal Power Chokes Toroid Inductor	A
APPR. JLU	7/13/04	SIZE: DIM. UNITS: B	REV A
		SCALE: 2=1	

PARTS LIST

CWS Coil Winding Specialist  
 www.cwcoilwinding.com  
 1510 E. Edinger Ave.  
 Unit B, Santa Ana, CA 92705